

Technische Daten / Technical Data

Gehäuse	Stahl vernickelt, verzinkt
Shell	Steel, nickel plated, tin plated
Isolierkörper	Thermoplast, nach UL94 V-0
Insulator	Thermoplastic, rated UL94 V-0
Kontaktmaterial	Kupferlegierung
Contact Material	Copper alloy
Kontaktoberfläche	Gold über Nickel
Contact Surface	Gold over nickel
Durchgangswiderstand	< 20 mΩ
Contact Resistance	< 20 mΩ
Isolationswiderstand	> 500 MΩ
Insulation Resistance	> 500 MΩ
Spannungsfestigkeit	500 V AC
Test Voltage	500 V AC
Nennstrom	3 A
Current Rating	3 A
Temperaturbereich	-55 °C ... +125 °C
Temperature Range	-55 °C ... +125 °C
Verarbeitung	Wellenlötverfahren
Processing	Wave soldering
Güteklasse	GK 3, min. 50 Steckzyklen, andere GK auf Anfrage
Quality Class	Quality class 3, min. 50 cycles, more quality options on request

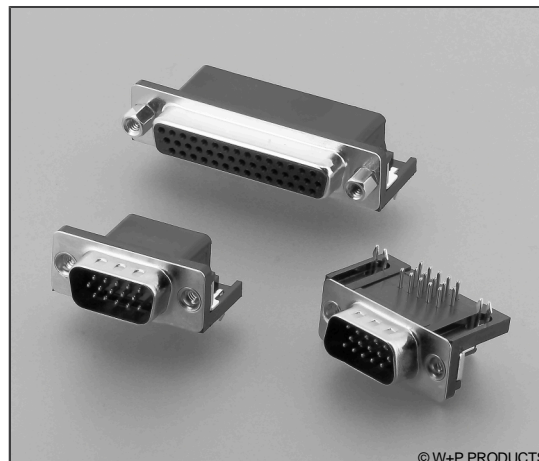

© W+P PRODUCTS

PCB-Layouts s. Tech. Info.
PCB Layouts in Tech. Info.

Stift / Male

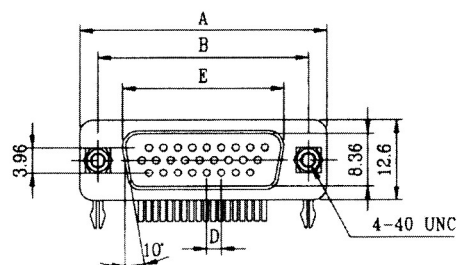

Buchse / Female

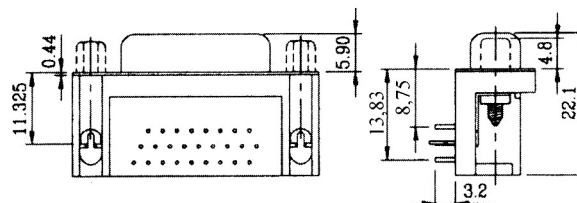
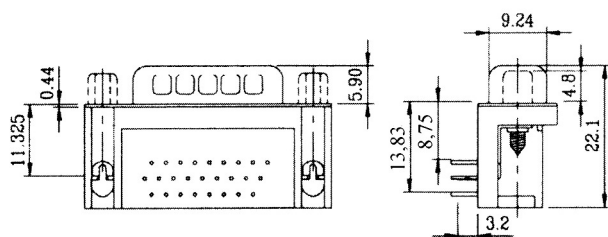
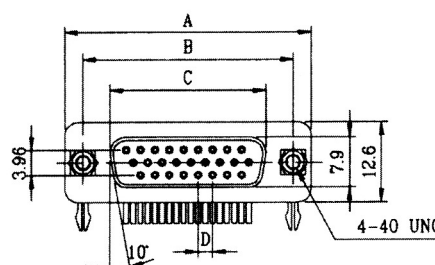

n	A	B	C	D	E
15	30,80	24,99	16,33	2,29	17,70
26	39,10	33,32	24,66	2,29	26,00
44	53,00	47,04	37,66	2,29	40,20
62	69,30	63,50	54,83	2,41	56,70

Series	Contacts*	Terminal*	Dimensions*	Bolts*
110	44	1	1	00

15/26/44/62

1 Stift
Male
2 Buchse
Female

1 Masseblech vernietet, Gewindeniet UNC 4-40
Riveted grounding brackets, UNC 4-40 rivet
2 Masseblech mit UNC 4-40 Gewinde
mit befestigten Bolzen (nur Bolts-Option 20),
Economy-Version
Grounding brackets with UNC 4-40 thread
with assembled bolts (only Bolts-option 20),
economy version

00 Ohne Bolzen
W/o bolts
10 Bolzen lose
Loose bolts
20 Bolzen montiert
Assembled bolts

* Dies ist ein **Bestellbeispiel** -
bitte durch Ihre Spezifikationen ersetzen.
* This is an **order example** -
please replace by your specifications.

Leiterplatten-Layouts für HD D-Sub-Verbinder

PCB Layouts for HD D-Sub Connectors

Gerade Ausführung / Straight Type

Stift / Male

Buchse / Female

15-pol.

15-pol.

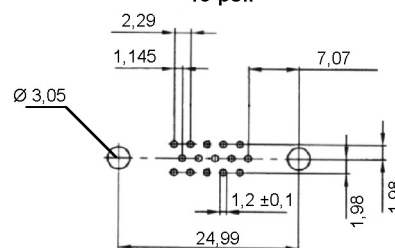
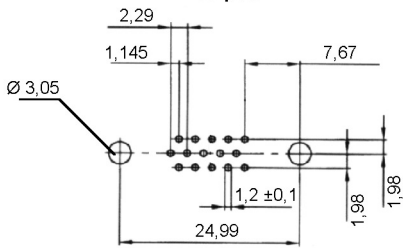

26-pol.

26-pol.

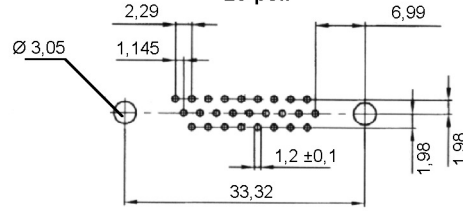
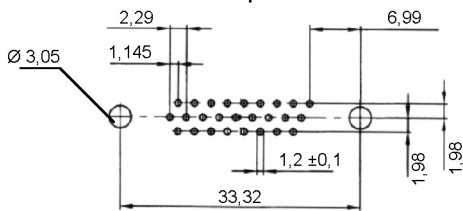

44-pol.

44-pol.

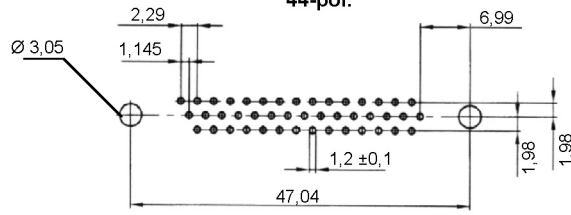
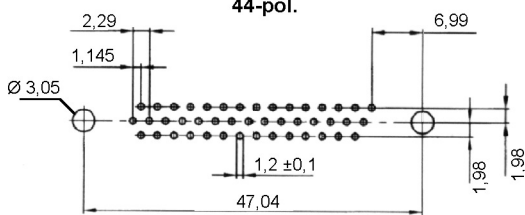

62-pol.

62-pol.

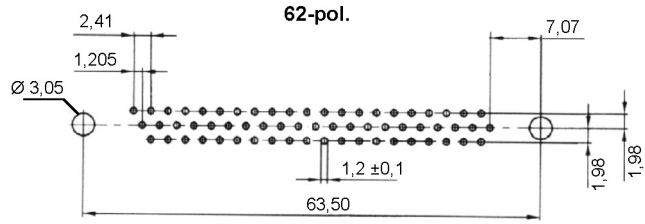
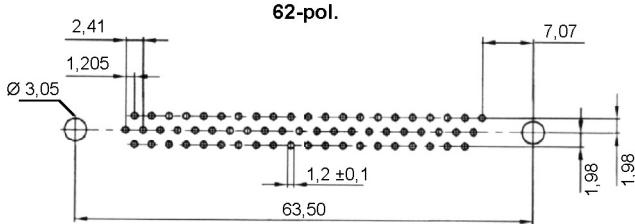

78-pol.

78-pol.

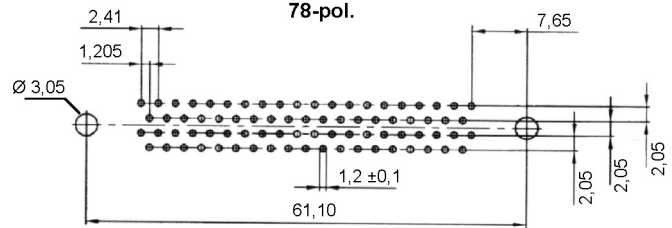
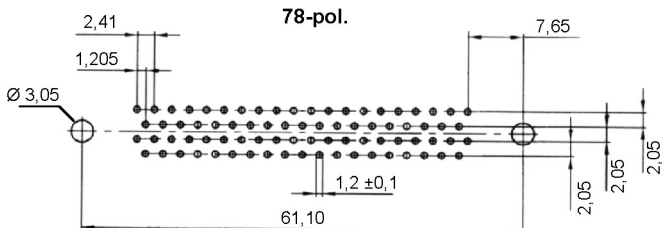

Gewinkelte Ausführung / Right-angled Type

Stift / Male

Buchse / Female

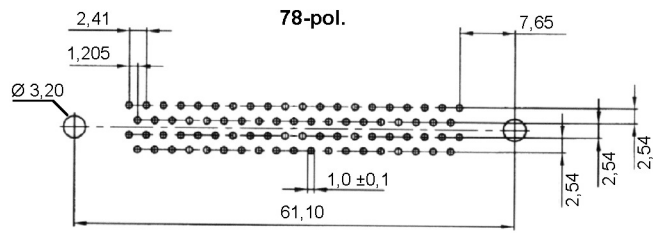
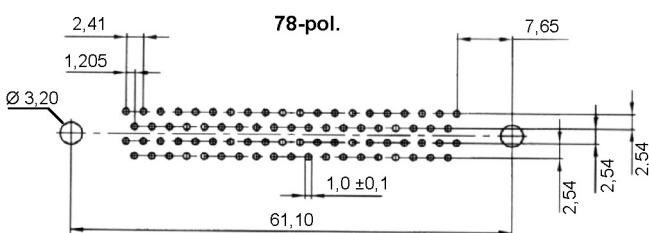
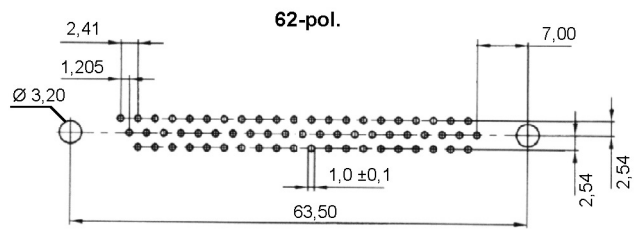
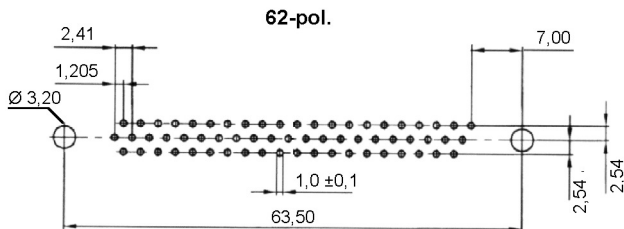
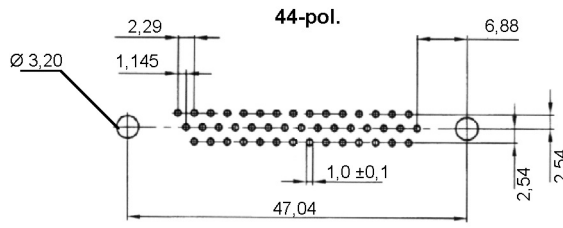
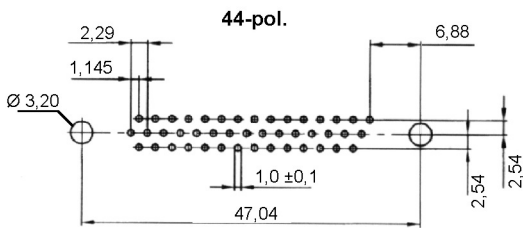
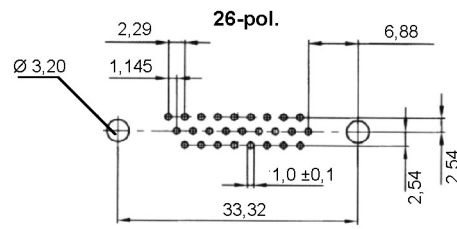
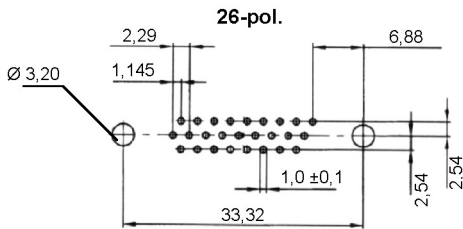
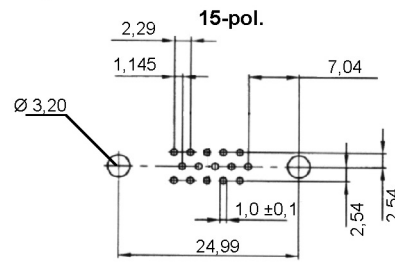
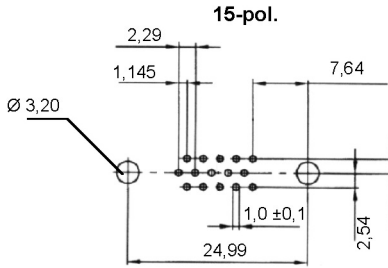

Informationen zum Wellen-Lötverfahren

Wave Soldering Information

Empfehlungen für das Wellenlötverfahren

Recommendations for Wave Soldering

Die Bauteile sollten bei einer Lötbadtemperatur von 260°C in max. 5 Sekunden verlötet werden.

Empfohlenes Wellenlötprofil:

