

## Crimp-Verbinder RM 2,50mm, gewinkelt, Einlöt-Kontakte Crimp Connectors, 2.50mm Pitch, Right-Angled, Solder-In Terminals

### Technische Daten / Technical Data

Isolierkörper <i>Insulator</i>	Thermoplast, nach UL94 V-0 <i>Thermoplastic, rated UL94 V-0</i>
Kontaktmaterial <i>Contact Material</i>	Kupferlegierung <i>Copper alloy</i>
Aderquerschnitt <i>Applicable wire Gauge</i>	AWG 28 ~ 22 <i>AWG 28 ~ 22</i>
Durchgangswiderstand <i>Contact Resistance</i>	< 20 mΩ <i>&lt; 20 mΩ</i>
Isolationswiderstand <i>Insulation Resistance</i>	> 1000 MΩ <i>&gt; 1000 MΩ</i>
Spannungsfestigkeit <i>Test Voltage</i>	800 V AC <i>800 V AC</i>
Nennspannung <i>Voltage Rating</i>	200 V AC <i>200 V AC</i>
Nennstrom <i>Current Rating</i>	2,5 A <i>2.5 A</i>
Temperaturbereich <i>Temperature Range</i>	-25 °C ... +85 °C <i>-25 °C ... +85 °C</i>
Verarbeitung <i>Processing</i>	Wellenlötverfahren <i>Wave soldering</i>

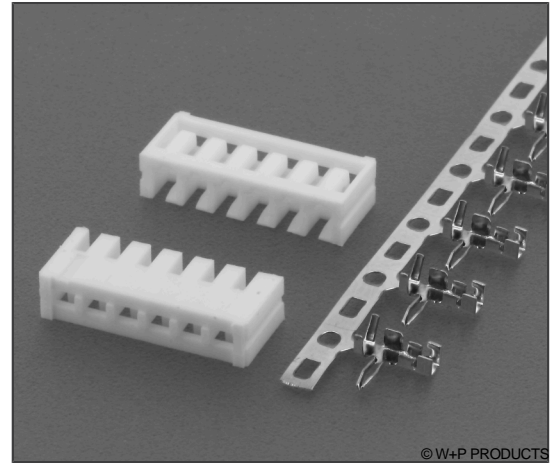

© W+P PRODUCTS

### Housing

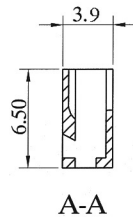
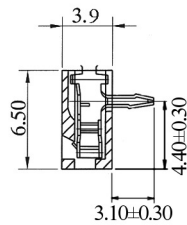
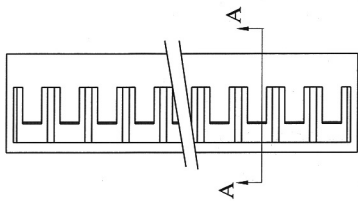
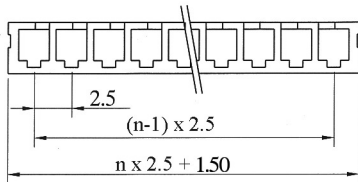

### Contact

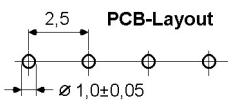
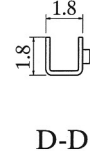
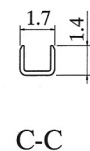
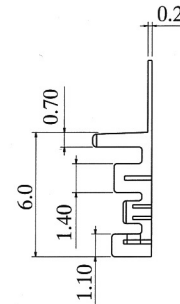
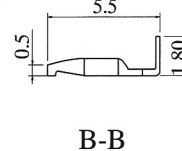
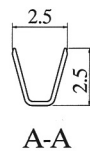
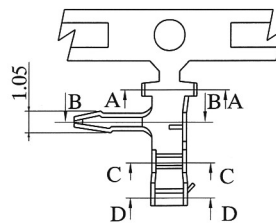

### Series

**572**

### Contacts\*

**10**

02-14

### Type

**1**

1 Crimp-Gehäuse  
Crimp housing

### Series

**572**

### Contacts

**01**

### Type

**2**

2 Crimp-Kontakte  
Crimp contacts

### Plating

**50**

50 Verzinkt  
Tin plated

\* Dies ist ein **Bestellbeispiel** -  
bitte durch Ihre Spezifikationen ersetzen.  
\* This is an **order example** -  
please replace by your specifications.

# Informationen zum Wellen-Lötverfahren

## Wave Soldering Information

### Empfehlungen für das Wellenlötverfahren

#### Recommendations for Wave Soldering

Die Bauteile sollten bei einer Lötbadtemperatur von 260°C in max. 5 Sekunden verlötet werden.

Empfohlenes Wellenlötprofil:

