

### Technische Daten / Technical Data

|  |   |
|--|---|
| Isolierkörper<br><i>Insulator</i>                    | Thermoplast, nach UL94 V-0<br><i>Thermoplastic, rated UL94 V-0</i>                |
| Kontaktmaterial<br><i>Contact Material</i>           | Vierkantstift 0,635mm, Kupferlegierung<br><i>0.635mm square pin, copper alloy</i> |
| Kontaktoberfläche<br><i>Contact Surface</i>          | Lt. Oberflächenoptionen, über Ni<br><i>Acc. to options (see below), over Ni</i>   |
| Durchgangswiderstand<br><i>Contact Resistance</i>    | < 20 mΩ   |
| Isolationswiderstand<br><i>Insulation Resistance</i> | > 1000 MΩ   |
| Spannungsfestigkeit<br><i>Test Voltage</i>           | 1000 V AC/DC  |
| Nennstrom<br><i>Current Rating</i>                   | 3 A   |
| Temperaturbereich<br><i>Temperature Range</i>        | -40 °C ... +105 °C  |
| Verarbeitung<br><i>Processing</i>                    | Reflow-Lötverfahren 260 °C / 5sec<br><i>Reflow soldering 260 °C / 5sec</i>        |

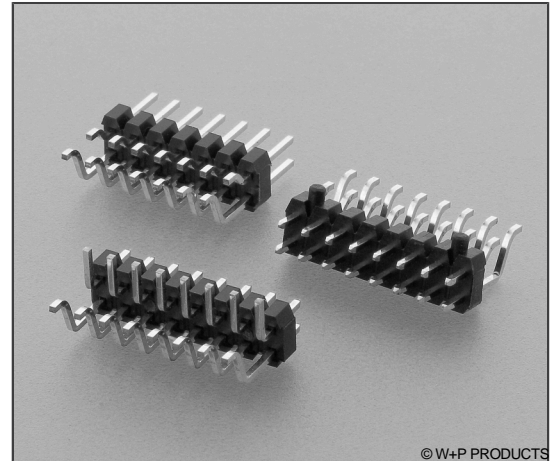

© W+P PRODUCTS

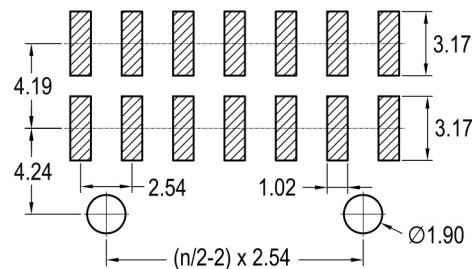
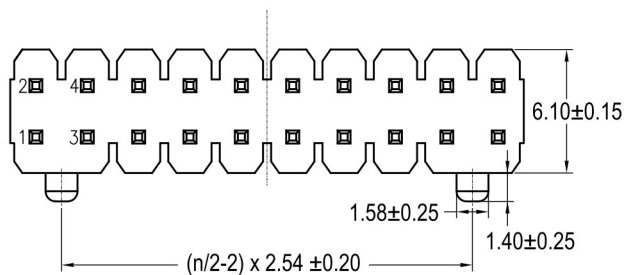

Recommended PCB Layout

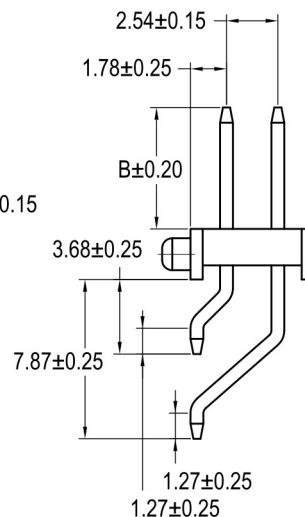
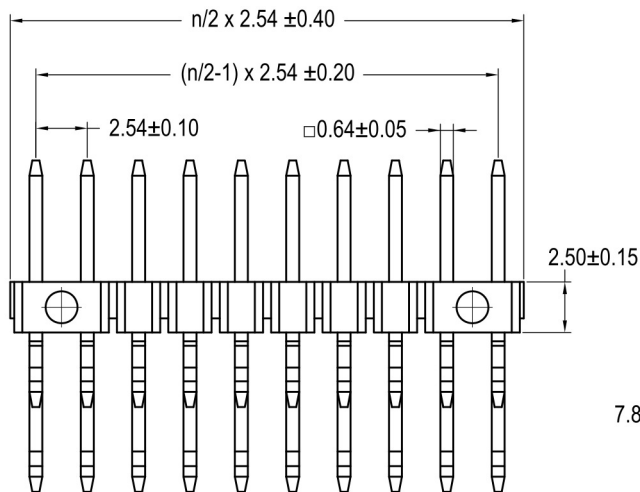

| Series      | Type                 | Dimensions*   | Contacts*                                   | Plating                                  | Locating Pegs*  | Packaging*                        |
|-------------|----------------------|---|---|--|---|-----------------------------------|
| <b>9232</b> | <b>1</b><br>1 Type M | <b>14</b><br>13 B=3.05mm<br>14 B=5.84mm<br>15 B=8.13mm<br>16 B=10.67mm<br>99- Kundenspezifisch<br>Customer-specific | <b>12</b><br>04-20 Zweireihig<br>Double row | <b>00</b><br>00 Vergoldet<br>Gold-plated | <b>10</b><br>00 Ohne Positionierhilfen<br>W/o locating pegs<br>10 Mit Positionierhilfen<br>With locating pegs | <b>PPTR</b><br>ST<br>PPST<br>PPTR |

### Lieferformen / Packaging Options:

**ST** In Stangen ohne Pick&Place-Pads / In tubes w/o Pick&Place-Pads  
**PPST** In Stangen mit PP-Pads / In tubes with PP-Pads  
**PPTR** Tape&Reel mit PP-Pads / Tape&Reel with PP-Pads

\* Dies ist ein **Bestellbeispiel** - bitte durch Ihre Spezifikationen ersetzen.  
 \* This is an **order example** - please replace by your specifications.