

Insulator	Thermoplastic, rated UL94 V-0
Contact Material	Copper alloy
Contact Surface	Au over Ni
Contact Resistance	20 mΩ max.
Insulation Resistance	1000 MΩ min.
Test Voltage	500 V AC/DC
Current Rating	1.0 A
Temperature Range	-40 °C ... +105 °C
Processing Temperature	230 °C for 30-60 seconds (260 °C for 10 seconds)

Recommended P.C.B Layout(Top Side)  
(PCB BOARD TOLERANCE±0.05)

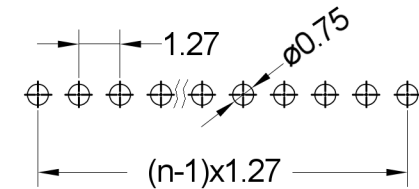

Series	Contacts *	Dimensions *	Plating
<b>46-702</b>	<b>010</b> 002-020 Einreihig Single row	<b>10</b> B=2,80 C=2,60 H=1,70mm 20 B=6,00 C=3,00 H=1,70mm	<b>00</b> Vergoldet Gold plated

X.X	±0.30
X.XX	±0.20
X.XXX	±0.10
Angle	±3°
DIM	TOL



Serial Number <b>46-702</b>			
Part Name Pin Header, 1.27x2.54mm Pitch, Straight, Single Row			
Creation date 2021-11-10	Drawn AL	Approved PS	Approval date 2021-11-19
REACH (EG) Nr. 1907/2006 RoHS 2011/65/EU compliant		Scale %	Sheet

On release of the data sheet, previous releases are no longer valid. Dimensions and tolerances are subject to change.

Copying of this document, and giving it to others and the use or communication of the contents thereof, are forbidden without express authority. Offenders are liable to the full extent of the law. In the event of the grant of a patent or the registration of a utility model or design.

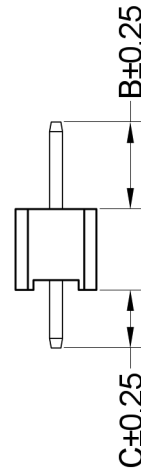
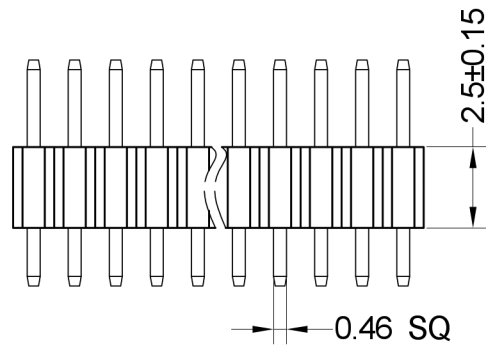
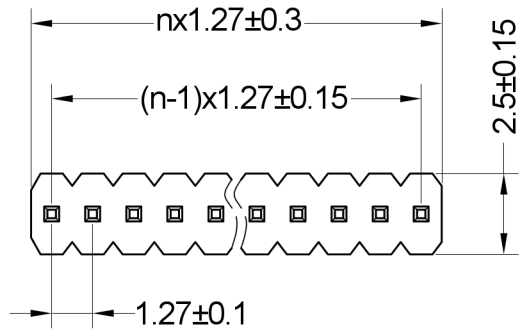

Insulator	Thermoplastic, rated UL94 V-0
Contact Material	Copper alloy
Contact Surface	Au over Ni
Contact Resistance	20 mΩ max.
Insulation Resistance	1000 MΩ min.
Test Voltage	500 V AC/DC
Current Rating	1.0 A
Temperature Range	-40 °C ... +105 °C
Processing Temperature	230 °C for 30-60 seconds (260 °C for 10 seconds)

Recommended P.C.B Layout (Top Side)  
(PCB BOARD TOLERANCE ±0.05)

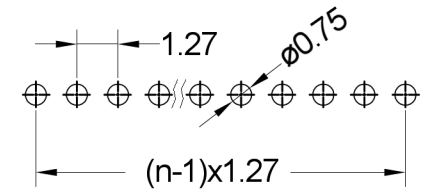

<b>Series</b>	<b>Contacts *</b>	<b>Dimensions *</b>	<b>Plating</b>
<b>46-702</b>	<b>026</b>	<b>30</b>	<b>00</b>
	002-050 Einreihig Single row	30 B=2,80 C=2,60mm H=2,50mm 40 B=6,00 C=3,00mm H=2,50mm	00 Vergoldet Gold plated

X.X	±0.30
X.XX	±0.20
X.XXX	±0.10
Angle	±3°
DIM	TOL



Serial Number <b>46-702</b>			
Part Name Pin Header, 1.27x2.54mm Pitch, Straight, Single Row			
Creation date 2019-01-10	Drawn AL	Approved PS	Approval date 2019-01-10
REACH (EG) Nr. 1907/2006 RoHS 2011/65/EU compliant		Scale %	Sheet

On release of the data sheet, previous releases are no longer valid. Dimensions and tolerances are subject to change.

Copying of this document, and giving it to others and the use or communication of the contents thereof, are forbidden without express authority. Offenders are liable to the registration of a utility model or design.

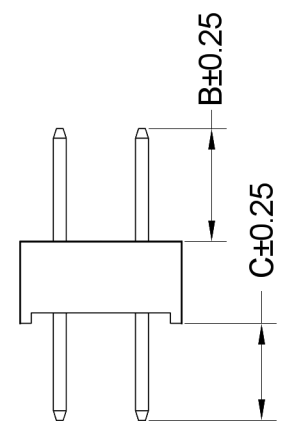
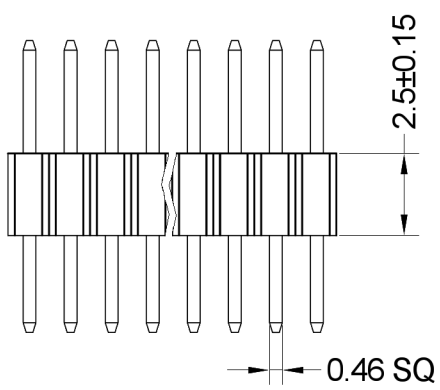
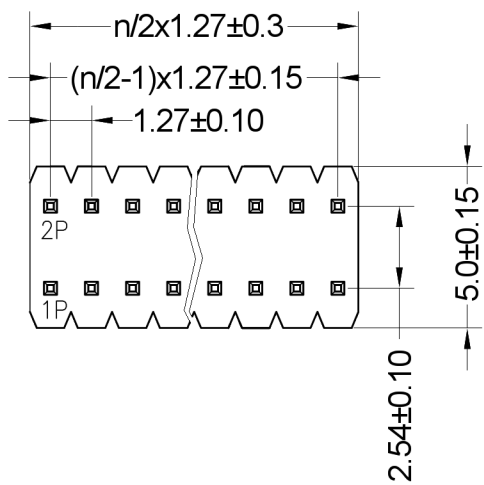

Recommended P.C.B Layout (Top Side)  
(PCB BOARD TOLERANCE ± 0.05)

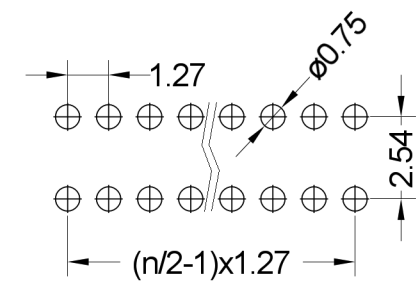

Insulator	Thermoplastic, rated UL94 V-0
Contact Material	Copper alloy
Contact Surface	Au over Ni
Contact Resistance	20 mΩ max.
Insulation Resistance	1000 MΩ min.
Test Voltage	500 V AC/DC
Current Rating	1.0 A
Temperature Range	-40 °C ... +105 °C
Processing Temperature	230 °C for 30-60 seconds (260 °C for 10 seconds)

Series	Contacts *	Dimensions *	Plating
<b>46-703</b>	<b>026</b> 004-100 Zweireihig Double row	<b>60</b> 50 B=2,80 C=2,60mm H=2,50mm 60 B=6,00 C=3,00mm H=2,50mm	<b>00</b> 00 Vergoldet Gold plated

X.X	±0.30
X.XX	±0.20
X.XXX	±0.10
Angle	±3°
DIM	TOL



Serial Number <b>46-703</b>			
Part Name Pin Header, 1.27x2.54mm Pitch, Straight, Double Row			
Creation date 2019-01-10	Drawn AL	Approved PS	Approval date 2019-01-10
REACH (EG) Nr. 1907/2006 RoHS 2011/65/EU compliant		Scale %	Sheet

On release of the data sheet, previous releases are no longer valid. Dimensions are subject to change.

Copying of this document, and giving it to others and the use or communication of the contents thereof, are forbidden without express authority. Offenders are liable to the registration of a utility model or design.