

On release of the data sheet, previous releases are no longer valid. Dimensions are subject to change.

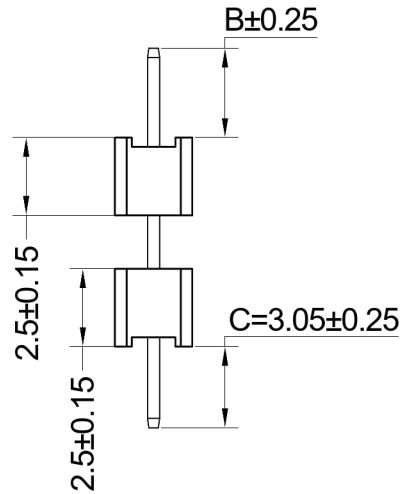

Insulator	Thermoplastic, rated UL94 V-0
Contact Material	Copper alloy, 0.46mm square pin
Contact Surface	Au over Ni
Contact Resistance	20 mΩ max.
Insulation Resistance	1000 MΩ min.
Test Voltage	500 V AC/DC
Current Rating	1.0 A
Temperature Range	-40 °C ... +105 °C
Processing Temperature	230 °C for 30-60 seconds (260 °C for 10 seconds)

Recommended P.C.B Layout (Top Side)
(PCB BOARD TOLERANCE ± 0.05)

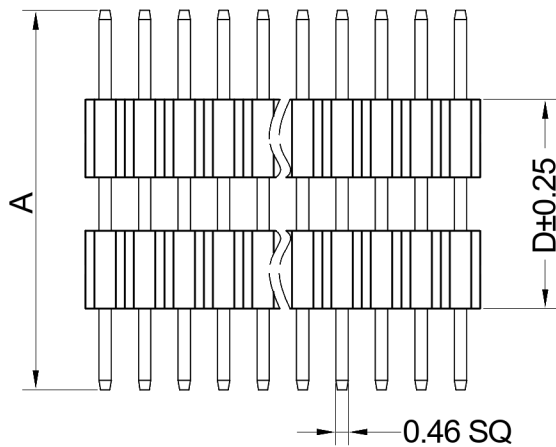
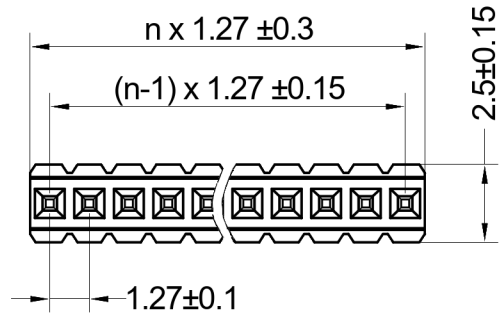
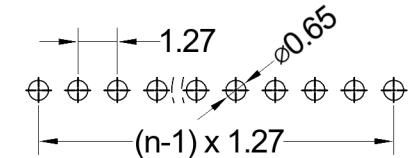

Series 46-704 — **Contacts*** 030 — **Dimensions*** 10 — **Plating** 00

02-40 Einreihig
Single row

10 A=11,00 B=2,87 D=5,08mm
15 A=12,90 B=3,05 D=6,80mm
20 A=15,90 B=3,05 D=9,80mm
25 A=17,90 B=3,05 D=11,80mm
30 A=21,00 B=3,05 D=14,90mm
A(mm) Kundenspezifisch (max. 45,0mm)
Customer-specific (max. 45,0mm)

00 Vergoldet
Gold plated

Max. Polzahl für Stiftmaße zwischen 21.0 - 45.0mm = 20P
Max. contact number for dimensions between 21.0-45.0mm = 20P

X.X	±0.30
X.XX	±0.20
X.XXX	±0.10
Angle	±3°
DIM	TOL



Serial Number 46-704			
Part Name Dual Body Pin Header, 1.27mm Pitch, Single Row			
Creation date 2022-05-11	Drawn AL	Approved PS	Approval date 2022-05-11
REACH (EG) Nr. 1907/2006 RoHS 2011/65/EU compliant		Scale %	Sheet

Copying of this document, and giving it to others and the use or communication of the contents thereof, are forbidden without express authority. Offenders are liable to the payment of damages. The copyright in the event of the grant of a patent or the registration of a utility model or design.

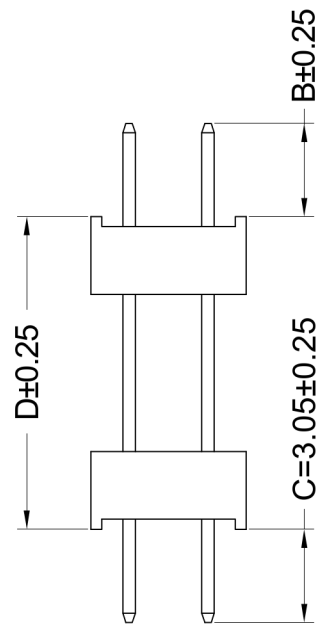
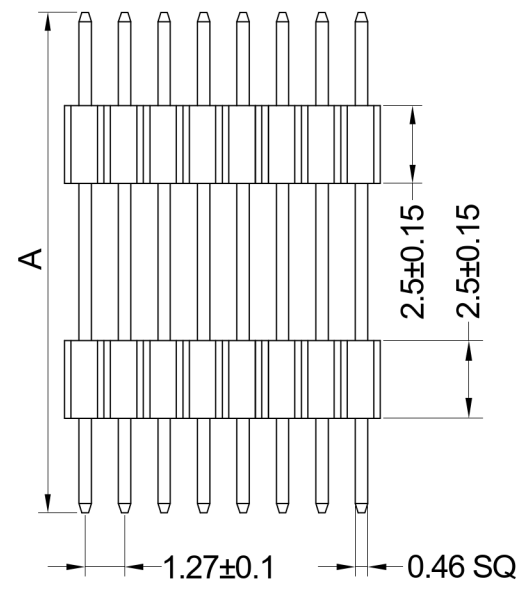
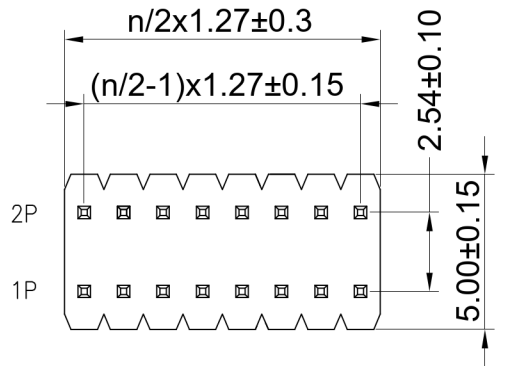

Recommended P.C.B Layout (Top Side)
(PCB BOARD TOLERANCE ± 0.05)

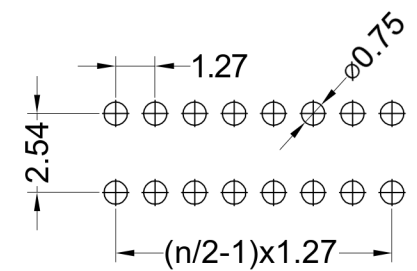

Insulator	Thermoplastic, rated UL94 V-0
Contact Material	Copper alloy, 0.46mm square pin
Contact Surface	Au over Ni
Contact Resistance	20 mΩ max.
Insulation Resistance	1000 MΩ min.
Test Voltage	500 V AC/DC
Current Rating	1.0 A
Temperature Range	-40 °C ... +105 °C
Processing Temperature	230 °C for 30-60 seconds (260 °C for 10 seconds)

On release of the data sheet, previous releases are no longer valid. Dimensions and tolerances are subject to change.

Copying of this document, and giving it to others and the use or communication of the contents thereof, are forbidden without express authority. Offenders are liable to the full extent of the law. In the event of the grant of a patent or the registration of a utility model or design.

Series	Contacts *	Dimensions*	Plating
46-705	020 04-80 Zweireihig Double row	10 10 A=11,00 B=2,87 D=5,08mm 15 A=12,90 B=3,05 D=6,80mm 20 A=15,90 B=3,05 D=9,80mm 25 A=17,90 B=3,05 D=11,80mm 30 A=21,00 B=3,05 D=14,90mm A (mm) Kundenspezifisch (max. 21mm) Customer-specific (max. 21mm)	00 00 Vergoldet Gold plated

X.X	±0.30	W+P WE CONNECT IT	Serial Number 46-705			
X.XX	±0.20		Part Name Dual Body Pin Header, 1.27x2.54mm Pitch, Double Row			
X.XXX	±0.10		Creation date 2022-05-11	Drawn AL	Approved PS	Approval date 2022-05-11
Angle	±3°		REACH (EG) Nr. 1907/2006 RoHS 2011/65/EU compliant		Scale %	Sheet
DIM	TOL					