

On release of the data sheet, previous releases are no longer valid. Dimensions and tolerances are subject to change.

Copying of this document, and giving it to others and the use or communication of the contents thereof, are forbidden without express authority. Offenders are liable to the registration of a utility model or design.

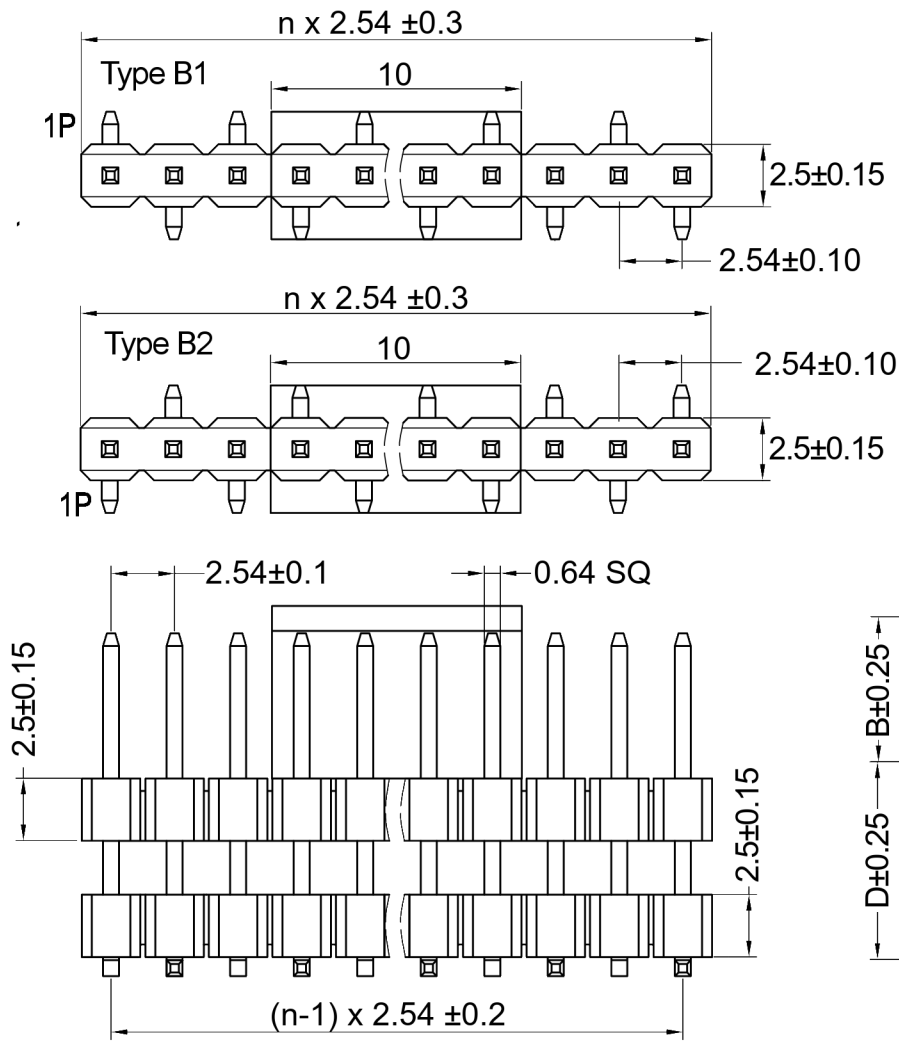

Insulator: Thermoplastic, rated UL94 V-0
 Contact Material: Copper alloy
 Contact Surface: Au over Ni
 Contact Resistance: 20 mΩ max.
 Insulation Resistance: 1000 MΩ min.
 Test Voltage: 1000 V AC/DC
 Current Rating: 3.0 A
 Temperature Range: -40 °C ... +105 °C
 Processing Temperature: 230 °C for 30-60 seconds
 (260 °C for 10 seconds)

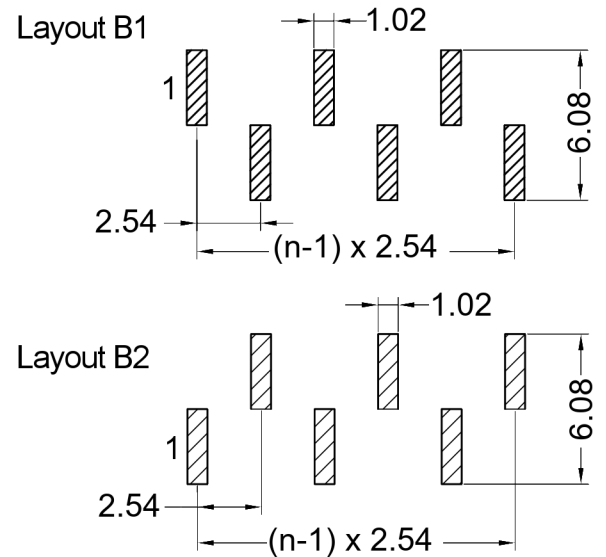

Recommended P.C.B Layout (Top Side)
 (PCB BOARD TOLERANCE ± 0.05)

Series 46-9533 — **Dimensions*** 14 — **Contacts*** 10 — **Plating** 00 — **Layout*** 1 — **Locating Pegs** 00 — **Packaging*** PPST

14 B=5,7 D=6,3mm
 15 B=5,7 D=7,1mm
 16 B=5,7 D=10,1mm
 99 Kundenspezifisch
 Customer-specific

03-20 Einreihig
 Single row

00 Vergoldet
 Gold plated

1 Layout B1
 2 Layout B2

00 Ohne Pos.hilfen
 W/o loc. pegs

ST In Stangen ohne Pick&Place-Pads / In tubes w/o Pick&Place-Pads
 PPST In Stangen mit P&P-Pads / In tubes with P&P-Pads
 PPTR Tape & Reel mit P&P-Pads / Tape & Reel with P&P-Pads

X.X	±0.30
X.XX	±0.20
X.XXX	±0.10
Angle	±3°
DIM	TOL



Serial Number 46-9533			
Part Name SMT Dual Body Pin Header, 2.54mm Pitch, Single Row			
Creation date 2022-05-11	Drawn AL	Approved PS	Approval date 2022-05-11
REACH (EG) Nr. 1907/2006 RoHS 2011/65/EU compliant		Scale %	Sheet

On release of the data sheet, previous releases are no longer valid. Dimensions and tolerances are subject to change.

Copying of this document, and giving it to others and the use or communication of the contents thereof, are forbidden without express authority. Offenders are liable to the registration of a utility model or design.

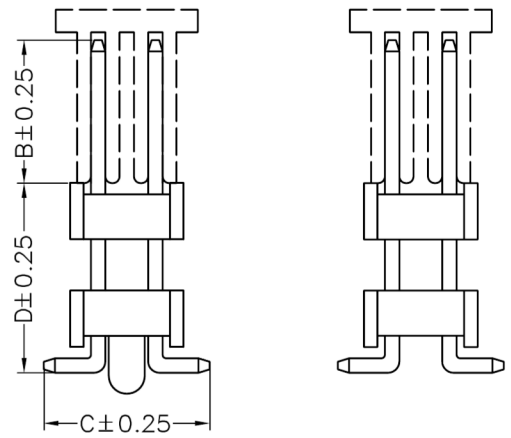
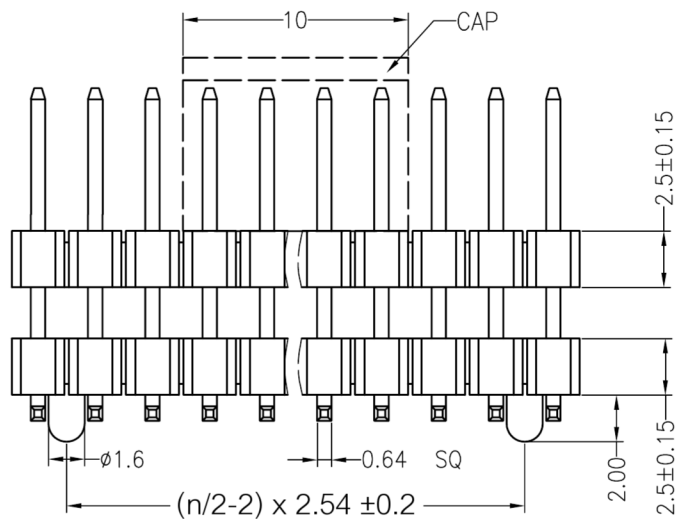
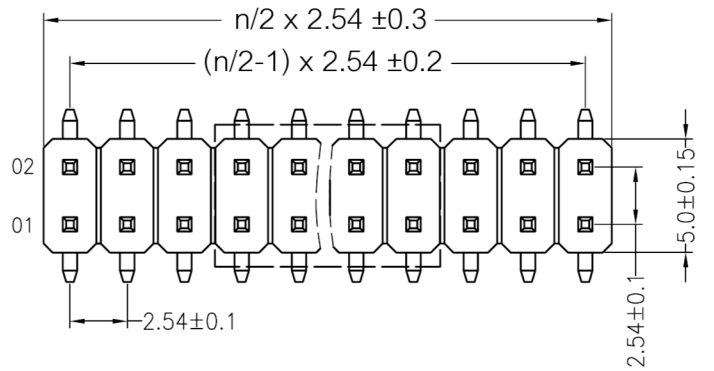

Recommended P.C.B Layout (Top Side)
(PCB BOARD TOLERANCE ± 0.05)

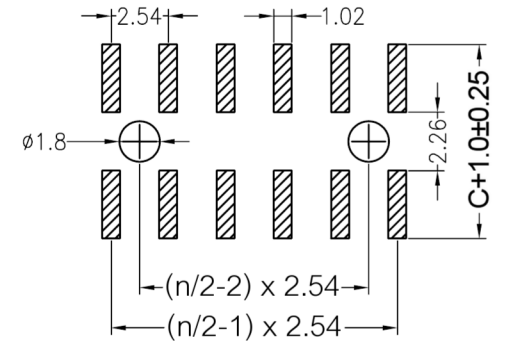

Insulator	Thermoplastic, rated UL94 V-0
Contact Material	Copper alloy
Contact Surface	Au over Ni
Contact Resistance	20 mΩ max.
Insulation Resistance	1000 MΩ min.
Test Voltage	1000 V AC/DC
Current Rating	3.0 A
Temperature Range	-40 °C ... +105 °C
Processing Temperature	230 °C for 30-60 seconds (260 °C for 5 seconds)

Series 46-9133 **Dimensions *** 15 **Contacts *** 08 **Plating** 00 **Layout** 0 **Locating Pegs *** 00 **Packaging *** PPST

14 B=5.7 C=7.5 D=6.3mm
15 B=5.7 C=7.5 D=7.1mm
16 B=5.7 C=7.5 D=10.1mm
99 Kundenspezifisch
Customer-specific

04-60 Zweireihig
Double row

00 Vergoldet
Gold plated

00 Ohne Pos.hilfen
W/o loc. pegs
10 Mit Pos.hilfen
With loc. pegs

ST In Stangen ohne Pick&Place-Pads / *In tubes w/o Pick&Place-Pads*
PPST In Stangen mit P&P-Pads / *In tubes with P&P-Pads*
PPTR Tape & Reel mit P&P-Pads / *Tape & Reel with P&P-Pads*

X.X	±0.30
X.XX	±0.20
X.XXX	±0.10
Angle	±3°
DIM	TOL



Serial Number 46-9133			
Part Name SMT Dual Body Pin Header, 2.54mm Pitch, Double Row			
Creation date 2019-08-07	Drawn AL	Approved PS	Approval date 2020-01-08
REACH (EG) Nr. 1907/2006 RoHS 2011/65/EU compliant		Scale %	Sheet