

Technische Daten / Technical Data

Gehäuse	Stahl vernickelt, verzinkt
Shell	Steel, nickel plated, tin plated
Isolierkörper	Thermoplast, nach UL94 V-0
Insulator	Thermoplastic, rated UL94 V-0
Kontaktmaterial	Kupferlegierung
Contact Material	Copper alloy
Kontaktoberfläche	sel. Gold über Nickel
Contact Surface	sel. Gold over nickel
Aderquerschnitt	AWG 20 max.
Applicable wire Gauge	AWG 20 max.
RoHS-Ausnahmen 6a-I / 6c	keine; mit Befestigungsoption: ja
RoHS Exemptions 6a-I / 6c	none; with mounting options: yes
Durchgangswiderstand	< 20 mΩ
Contact Resistance	< 20 mΩ
Isolationswiderstand	> 500 MΩ
Insulation Resistance	> 500 MΩ
Spannungsfestigkeit	500 V AC
Test Voltage	500 V AC
Nennstrom	3 A
Current Rating	3 A
Temperaturbereich	-55 °C ... +105 °C
Temperature Range	-55 °C ... +105 °C

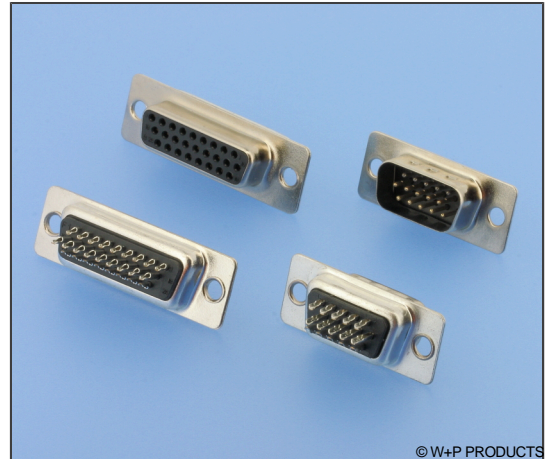

© W+P PRODUCTS

Stift / Male

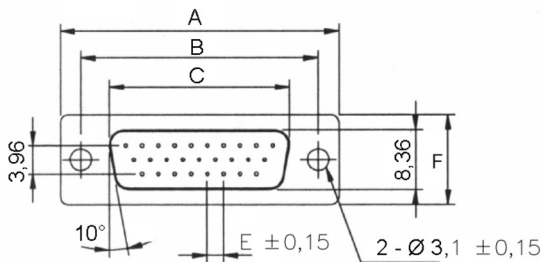

Buchse / Female

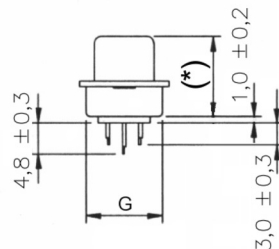
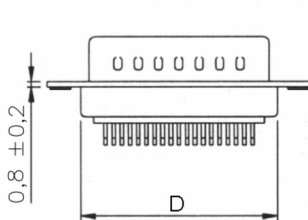
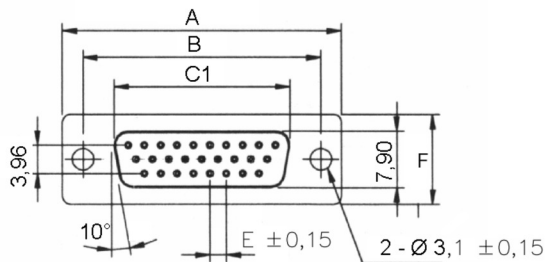

* Female: 10.6 ± 0.2

Male: 10.9 ± 0.2

n	A	B	C	C1	D	E	F	G
15	30,80	25,00	16,90	16,30	19,30	2,30	12,55	10,60
26	39,10	33,30	25,30	24,70	27,50	2,30	12,55	10,60
44	53,00	47,00	38,80	38,30	41,00	2,30	12,55	10,60
62	69,30	63,50	55,40	54,80	57,30	2,40	12,55	10,60

Series

108

Contacts*

44

15/26/44/62
78 auf Anfrage
by request

Terminal*

1

1 Stift
Male
2 Buchse
Female

Quality

3

3 GK 3, min. 50 Steckzyklen
QC 3, min. 50 cycles
X- Andere GK auf Anfrage
other QC by request

Mounting*

0

0-6/B1/B2 Lt. Tech. Info.
See Tech. Info.

* Dies ist ein **Bestellbeispiel** -
bitte durch Ihre Spezifikationen ersetzen.
* This is an **order example** -
please replace by your specifications.

D-Sub Befestigungsoptionen

Mounting Options

Durchgangsloch / Through Hole

0 Durchgangsloch 3,05mm
3.05mm Through Hole

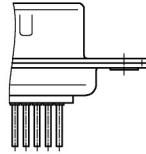

Gewindeniet vorn / Thread Rivet Front

B1 Gewindeniet UNC 4-40 (Anzugdrehmoment 0,4 Nm max.)
UNC 4-40 Thread Rivet (Tightening Torque 0.4 Nm max.)

B2 Gewindeniet M3 (Anzugdrehmoment 0,3 Nm max.)
M3 Thread Rivet (Tightening Torque 0.3 Nm max.)

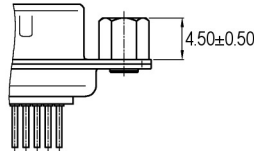

Gewindeniet hinten / Thread Rivet Back

1 Gewindeniet UNC 4-40 (Anzugdrehmoment 0,4 Nm max.)
UNC 4-40 Thread Rivet (Tightening Torque 0.4 Nm max.)

2 Gewindeniet M3 (Anzugdrehmoment 0,3 Nm max.)
M3 Thread Rivet (Tightening Torque 0.3 Nm max.)

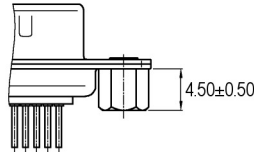

Gewindebolzen vorn / Thread Bolt Front

3 Gewindebolzen UNC 4-40 (Anzugdrehmoment 0,4 Nm max.)
UNC 4-40 Thread Bolt (Tightening Torque 0.4 Nm max.)

4 Gewindebolzen M3 (Anzugdrehmoment 0,3 Nm max.)
M3 Thread Bolt (Tightening Torque 0.3 Nm max.)

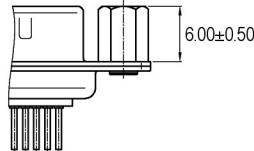

Gewindebolzen hinten / Thread Bolt Back

5 Gewindebolzen UNC 4-40 (Anzugdrehmoment 0,4 Nm max.)
UNC 4-40 Thread Bolt (Tightening Torque 0.4 Nm max.)

6 Gewindebolzen M3 (Anzugdrehmoment 0,3 Nm max.)
M3 Thread Bolt (Tightening Torque 0.3 Nm max.)

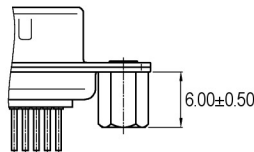

Board Locks

BL Board Lock mit UNC 4-40 Gewinde (Anzugdrehmoment 0,4 Nm max.)
Board Lock with UNC 4-40 Thread (Tightening Torque 0.4 Nm max.)

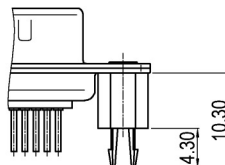

Combi-Locks

CL Combi-Lock mit UNC 4-40 Gewinde (Anzugdrehmoment 0,4 Nm max.)
Combi Lock with UNC 4-40 Thread (Tightening Torque 0.4 Nm max.)

