

Crimp-Rast-Buchsengehäuse RM 2,00mm, 1-/2-reihig Crimp Housings, 2.00mm Pitch, Single/Double Row

Technische Daten / Technical Data

Isolierkörper <i>Insulator</i>	Thermoplast, nach UL94 V-0 <i>Thermoplastic, rated UL94 V-0</i>
Kontaktmaterial <i>Contact Material</i>	Kupferlegierung <i>Copper alloy</i>
Aderquerschnitt <i>Applicable wire Gauge</i>	AWG 30 ~ 26 <i>AWG 30 ~ 26</i>
Durchgangswiderstand <i>Contact Resistance</i>	< 20 mΩ <i>< 20 mΩ</i>
Isolationswiderstand <i>Insulation Resistance</i>	> 1000 MΩ <i>> 1000 MΩ</i>
Spannungsfestigkeit <i>Test Voltage</i>	800 V AC <i>800 V AC</i>
Nennspannung <i>Voltage Rating</i>	250 V AC <i>250 V AC</i>
Nennstrom <i>Current Rating</i>	1 A <i>1 A</i>
Temperaturbereich <i>Temperature Range</i>	-25 °C ... +85 °C <i>-25 °C ... +85 °C</i>

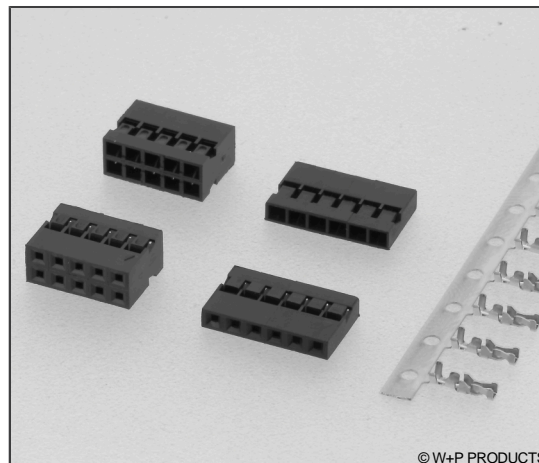

© W+P PRODUCTS

Passende Stiftleisten Serien:
Compatible Pin Headers:

314

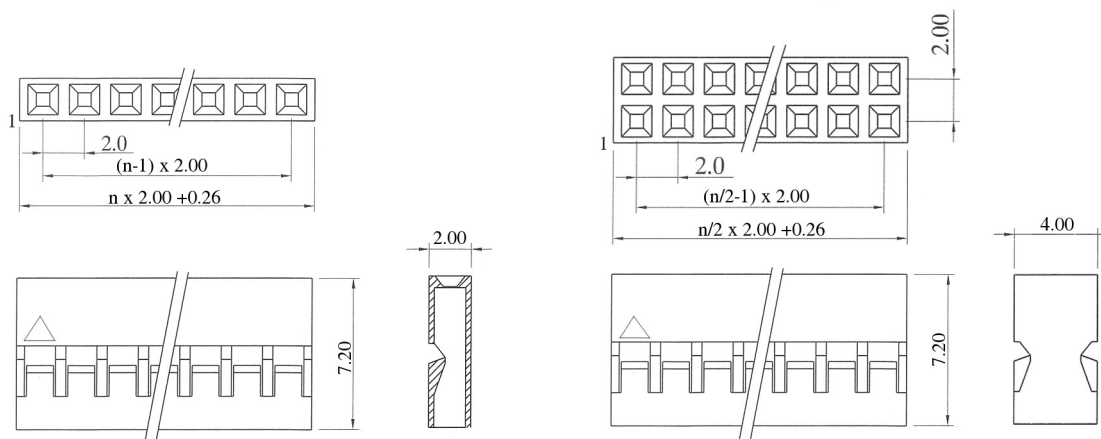

Series

518

Contacts*

40

02-30 Einreihig
Single row
04-80 Zweireihig
Double row

Type*

2

1 Buchsengehäuse einreihig
Housing single row
2 Buchsengehäuse zweireihig
Housing double row

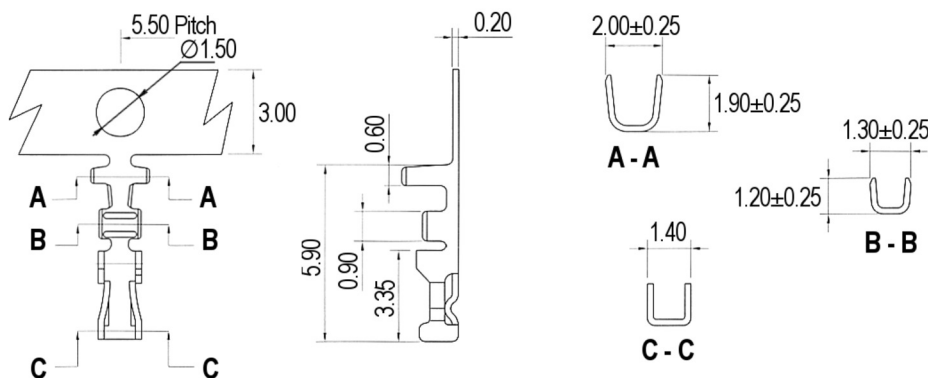

Series

518

Contacts

01

Type

3

3 Kontakte
Contacts

Plating

00

00 Vergoldet
Gold plated

Retention Force (Optional)*

1

[] Normale Haltekräfte
Normal retention forces
1 Erhöhte Haltekräfte (für 2-6 Kontakte)
Raised retention forces (for 2-6 contacts)

* Dies ist ein **Bestellbeispiel** -
bitte durch Ihre Spezifikationen ersetzen.
* This is an **order example** -
please replace by your specifications.