

## LED-Verbinder RM 4mm - fliegender Klemmenblock, AWG 24-22 LED-Connectors 4mm Pitch - Wire-to-Wire Terminal Block, AWG 24-22

### Technische Daten / Technical Data

Isolierkörper <i>Insulator</i>	Thermoplast, nach UL94 V-0 <i>Thermoplastic, rated UL94 V-0</i>
Farbe <i>Colour</i>	Beige <i>Beige</i>
Kontaktmaterial <i>Contact Material</i>	Kupferlegierung <i>Copper alloy</i>
Kontaktfläche <i>Contact Surface</i>	Verzinkt <i>Tin plated</i>
Aderquerschnitt <i>Applicable wire Gauge</i>	AWG 24 ~ 22 <i>AWG 24 ~ 22</i>
Durchgangswiderstand <i>Contact Resistance</i>	< 20 mΩ <i>&lt; 20 mΩ</i>
Isolationswiderstand <i>Insulation Resistance</i>	> 1000 MΩ <i>&gt; 1000 MΩ</i>
Spannungsfestigkeit <i>Test Voltage</i>	1000 V AC <i>1000 V AC</i>
Nennspannung <i>Voltage Rating</i>	275 V AC/DC <i>275 V AC/DC</i>
Nennstrom <i>Current Rating</i>	1 A <i>1 A</i>
Temperaturbereich <i>Temperature Range</i>	-40 °C ... +110 °C <i>-40 °C ... +110 °C</i>

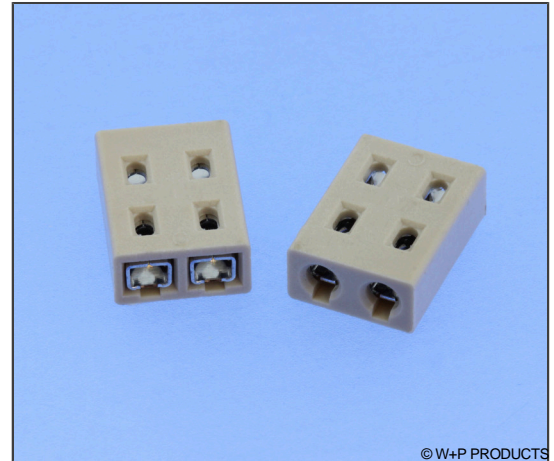

© W+P PRODUCTS

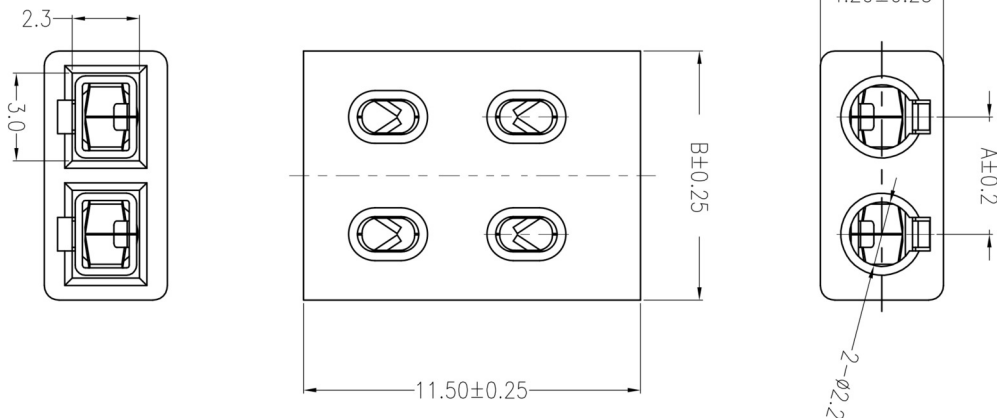

	DIM=A	DIM=B
01	/	B=4.50
02		A=4.00
03	A=8.00	B=12.50

<b>Series</b>	<b>Contacts*</b>	<b>Colour</b>	<b>Plating</b>
5266	02	20	50
	01-03	20 Beige Beige	50 Sn

\* Dies ist ein **Bestellbeispiel** - bitte durch Ihre Spezifikationen ersetzen.  
\* This is an **order example** - please replace by your specifications.