

Technische Daten / Technical Data

| | |
|--|---|
| Isolierkörper <i>Insulator</i> | Thermoplast, nach UL94 V-2 (UL94 V-0 auf Anfrage) <i>Thermoplastic, rated UL94 V-2 (UL94 V-0 on request)</i> |
| Kontaktmaterial <i>Contact Material</i> | Kupferlegierung <i>Copper alloy</i> |
| Kontaktoberfläche <i>Contact Surface</i> | Verzinkt <i>Tin plated</i> |
| Durchgangswiderstand <i>Contact Resistance</i> | < 20 mΩ |
| Isolationswiderstand <i>Insulation Resistance</i> | > 1000 MΩ |
| Spannungsfestigkeit <i>Test Voltage</i> | 1 kV AC |
| Nennspannung <i>Voltage Rating</i> | 250 V AC |
| Nennstrom <i>Current Rating</i> | 3 A |
| Temperaturbereich <i>Temperature Range</i> | -40 °C ... +105 °C |

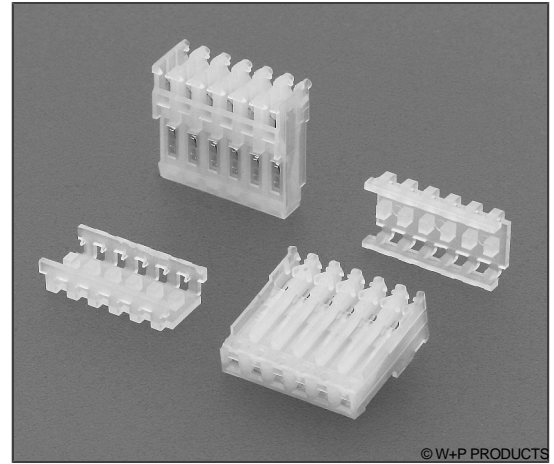

© W+P PRODUCTS

Passende Gegenstecker:
Compatible Connectors:
528

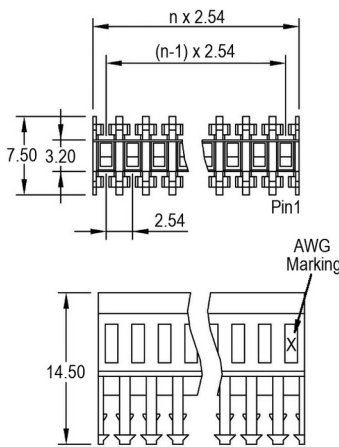

Type -0-

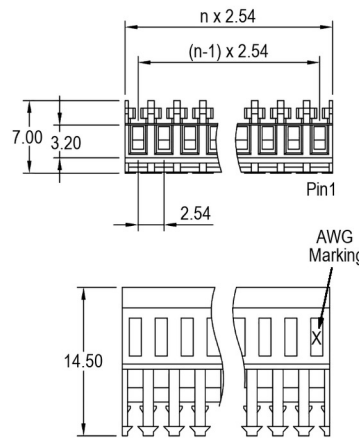

Type -1-

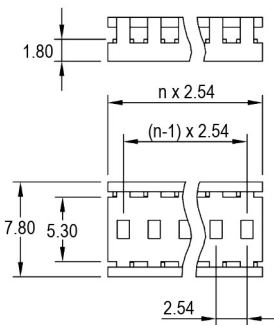

Type -2-

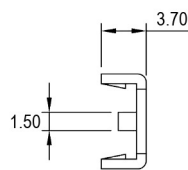

AWG Marking:

- 2 - AWG22
- 4 - AWG24
- 6 - AWG26
- 8 - AWG28

Kontaktpunkt 4,0mm; Einstecktiefe 8,0mm
4.0mm Contact point; 8.0mm insertion depth.

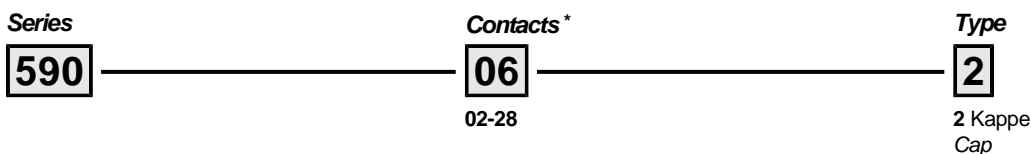
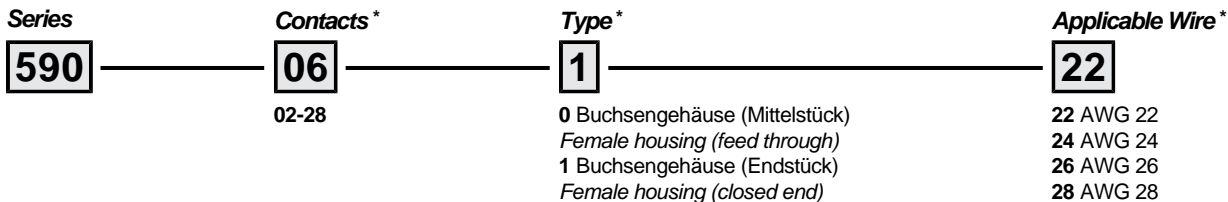

* Dies ist ein **Bestellbeispiel** - bitte durch Ihre Spezifikationen ersetzen.
* This is an **order example** - please replace by your specifications.