

HD D-Sub Steckverbinder zur Gehäusemontage, Lötkelche IP67 / IP68 HD D-Sub Panel Mount Connectors, Solder Cups IP67 / IP68

Technische Daten / Technical Data

Gehäuse	Stahl vernickelt
Shell	Nickel plated steel
Isolierkörper	Thermoplast
Insulator	Thermoplastic
Kontaktmaterial	Kupferlegierung
Contact Material	Copper alloy
Kontaktfläche	Vergoldet
Contact Surface	Gold plated
Durchgangswiderstand	< 20 mΩ
Contact Resistance	< 20 mΩ
Isolationswiderstand	> 500 MΩ
Insulation Resistance	> 500 MΩ
Spannungsfestigkeit	500 V AC @ 1min
Test Voltage	500 V AC @ 1min
Nennstrom	2 A
Current Rating	2 A
Temperaturbereich	-40 °C ... +105 °C
Temperature Range	-40 °C ... +105 °C

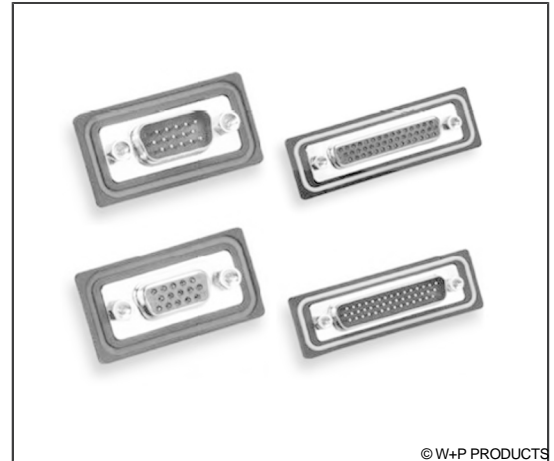

© W+P PRODUCTS

Passende Produkte:
Compatible Products:
WA112 W364 W901

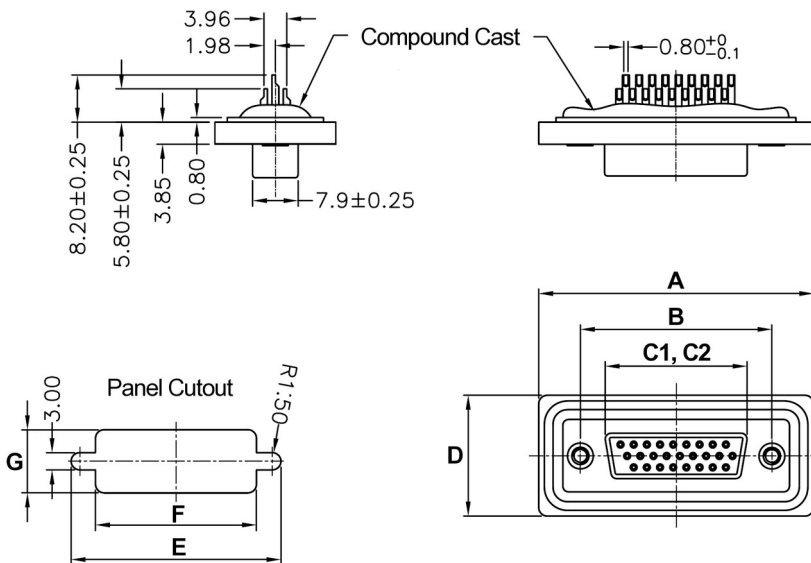

Pins	A	B	C1	C2	D	E	F	G
15	39.40	25.00	16.92	16.33	21.00	28.20	20.00	11.00
26	47.80	33.30	25.25	24.66	21.00	36.50	28.00	11.00
44	64.50	47.04	38.96	38.38	21.00	51.00	41.50	11.00
62	78.40	63.50	55.40	54.80	21.50	67.80	57.90	11.00
78	75.90	61.10	52.25	51.65	23.90	65.00	55.50	14.00

C1 for male connectors
C2 for female connectors

Series	Contacts*	IP Class	Contact Type*	Quality Class	Mounting
W112	26 15/26/44 (IP68) 62/78 (IP67)	8 8 IP68 7 IP67	2 1 Stiftkontakte Male terminals 2 Buchsenkontakte Female terminals	3 3 min. 50 Steckzyklen 50 mating cycles min.	00 00 UNC 4-40

Weitere Optionen auf Anfrage
More options on request

* Dies ist ein **Bestellbeispiel** -
bitte durch Ihre Spezifikationen ersetzen.
* This is an **order example** -
please replace by your specifications.