

Technische Daten / Technical Data

Isolierkörper <i>Insulator</i>	Hochtemperaturbeständiger Kunststoff nach UL94 V-0 <i>High Temperature Thermoplastic rated UL94 V-0</i>
Kontaktmaterial <i>Contact Material</i>	Kupferlegierung <i>Copper alloy</i>
Kontaktoberfläche <i>Contact Surface</i>	Lt. Oberflächenoptionen, über Ni <i>Acc. to options (see below), over Ni</i>
Aderquerschnitt <i>Applicable wire Gauge</i>	AWG 26 ~ 22 (Außendurchmesser 1,4 ~ 1,7mm) <i>AWG 26 ~ 22 (outer diameter 1.4 ~ 1.7mm)</i>
Durchgangswiderstand <i>Contact Resistance</i>	< 20 mΩ <i>< 20 mΩ</i>
Isolationswiderstand <i>Insulation Resistance</i>	> 1000 MΩ (initial) <i>> 1000 MΩ (initial)</i>
Spannungsfestigkeit <i>Test Voltage</i>	1000 V AC <i>1000 V AC</i>
Nennspannung <i>Voltage Rating</i>	100 V AC/DC <i>100 V AC/DC</i>
Nennstrom <i>Current Rating</i>	Bis zu 4 A (für AWG22) <i>Up to 4 A (for AWG22)</i>
Temperaturbereich <i>Temperature Range</i>	-55 °C ... +85 °C <i>-55 °C ... +85 °C</i>

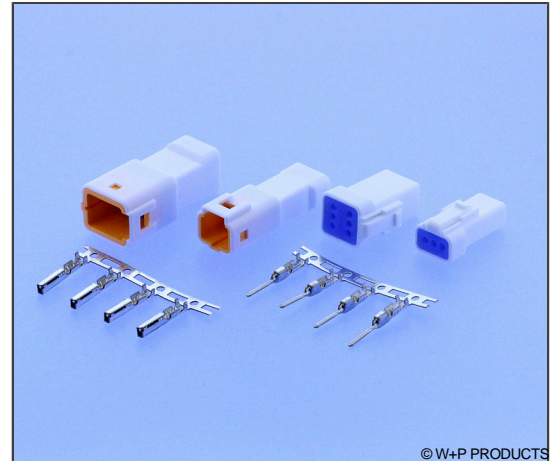

© W+P PRODUCTS

Dichtmaterial Silicongummi
Sealing Material Silicone Rubber

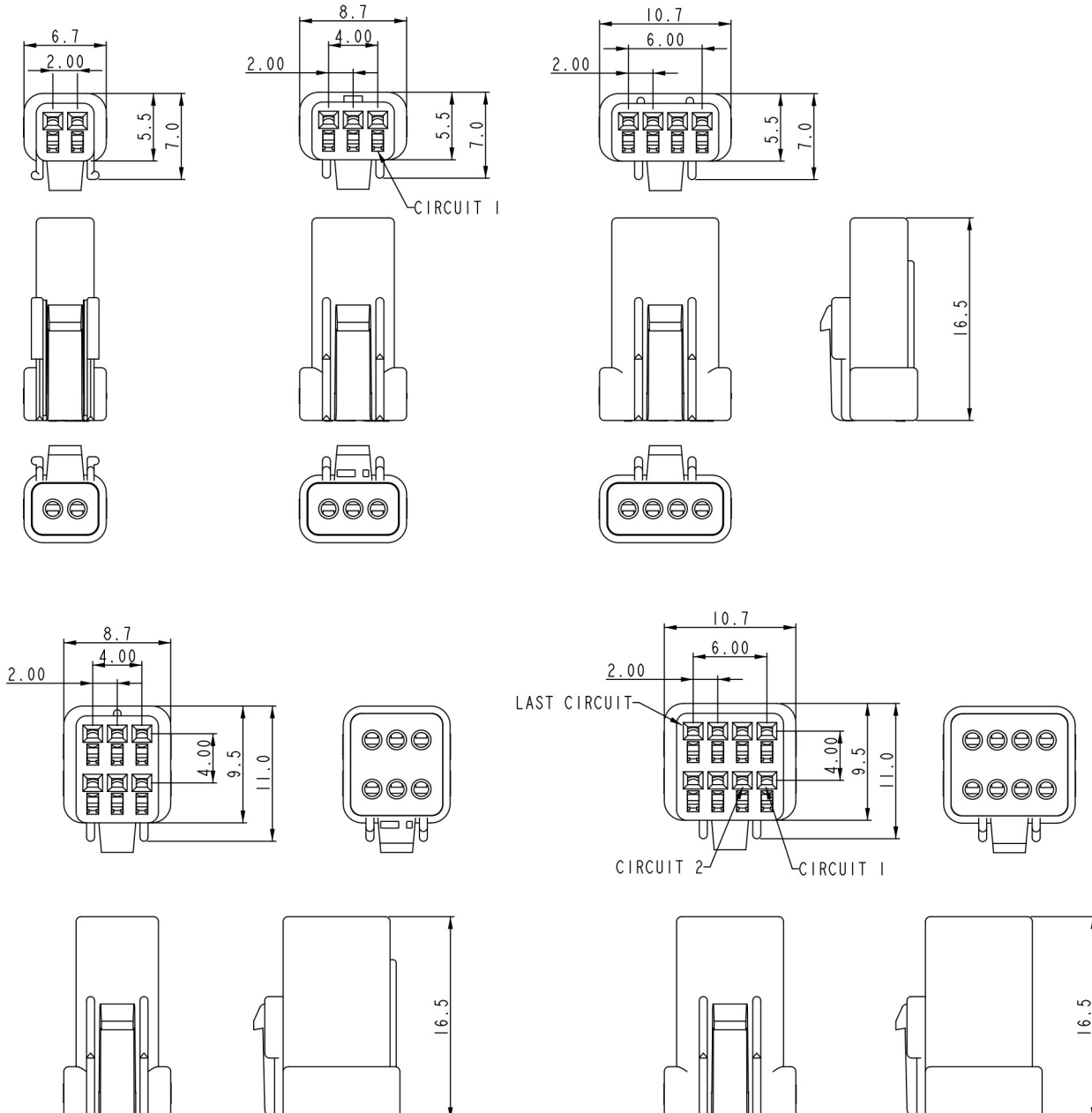

W521

Wire-To-Wire Steckverbinder RM 2mm - Waterproof IP67

Wire-To-Wire Connectors 2mm Pitch - Waterproof IP67

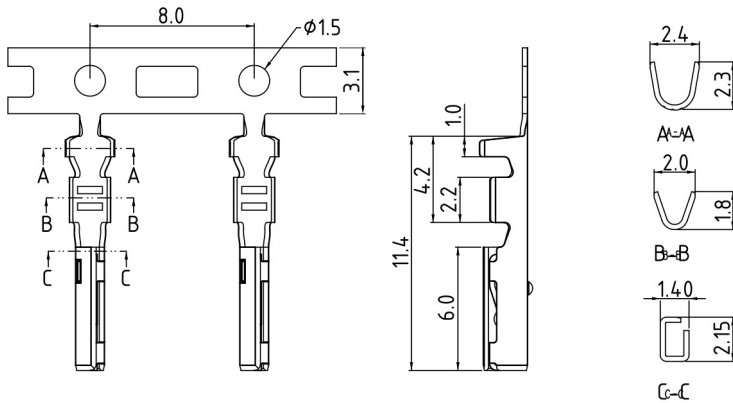

Series

W521

Contacts*

04

01 Für Kontakte
For terminals
02-04 Einreihig
Single row
06/08 Zweireihig
Double row

Type*

1

1 Buchsengehäuse IP67
Female Housing IP67
2 Buchsenkontakte
Female terminals

Rows*

1

1 Einreihig
Single row
2 Zweireihig
Double row
(nur für Gehäuse)
(for housings only)

Plating

50

50 Sn (nur für Kontakte)
Sn (for terminals only)

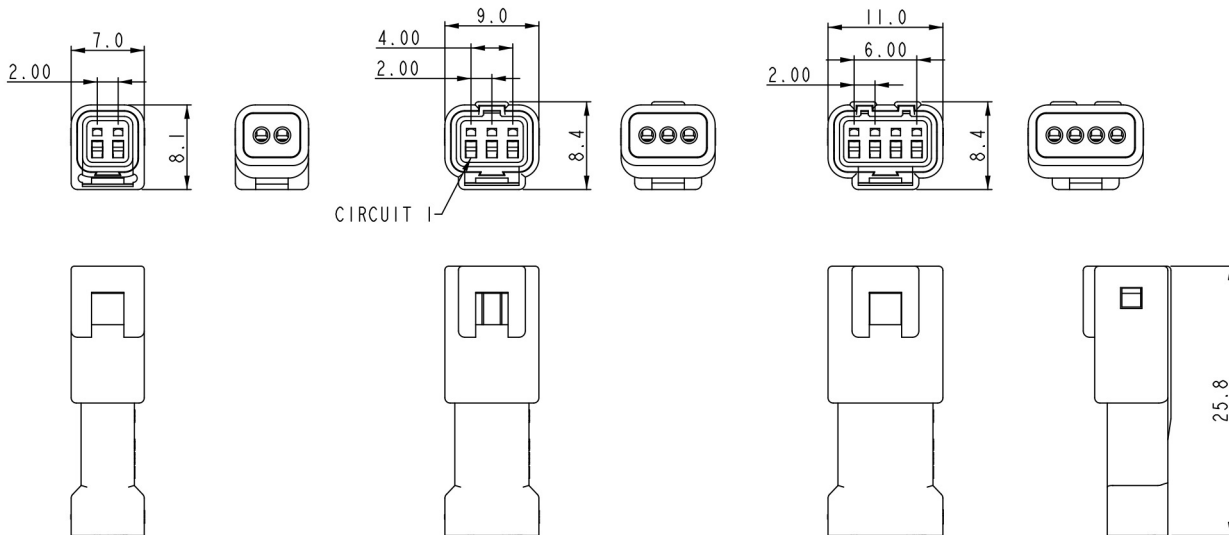

W521

Wire-To-Wire Steckverbinder RM 2mm - Waterproof IP67 Wire-To-Wire Connectors 2mm Pitch - Waterproof IP67

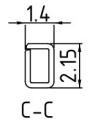
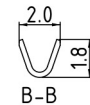
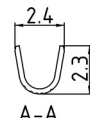
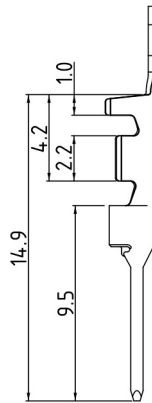
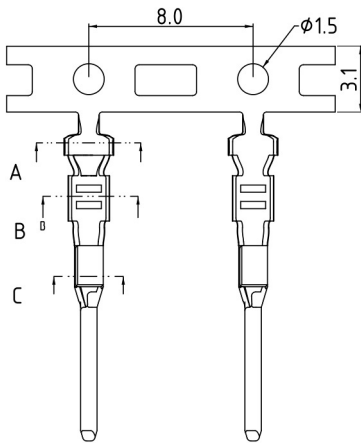
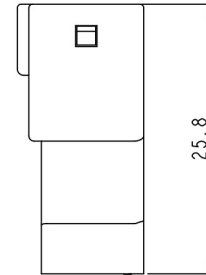
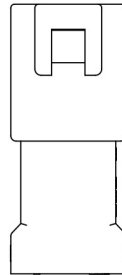
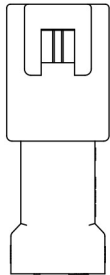
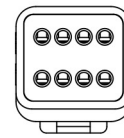
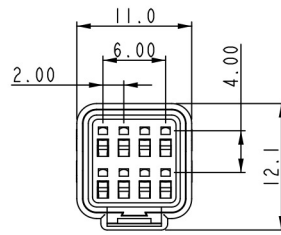
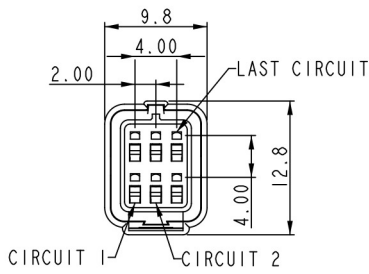

Series

W521

Contacts*

04

01 Für Kontakte
For terminals
02-04 Einreihig
Single row
06/08 Zweireihig
Double row

Type*

1

5 Stiftgehäuse IP67
Male Housing IP67
6 Stiftkontakte
Male contacts

Rows*

1

1 Einreihig
Single row
2 Zweireihig
Double row
(nur für Gehäuse)
(for housings only)

Plating

50

50 Sn (nur für Kontakte)
Sn (for terminals only)

* Dies ist ein **Bestellbeispiel** -
bitte durch Ihre Spezifikationen ersetzen.
* This is an **order example** -
please replace by your specifications.